

REVISION RECORD				
REV	ECO	DESCRIPTION	DRFT	CHKD

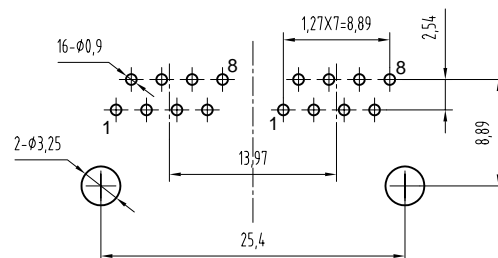
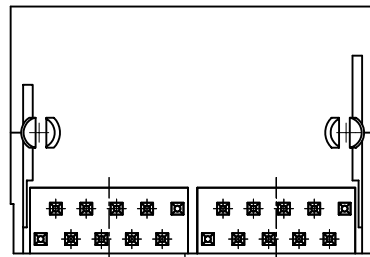
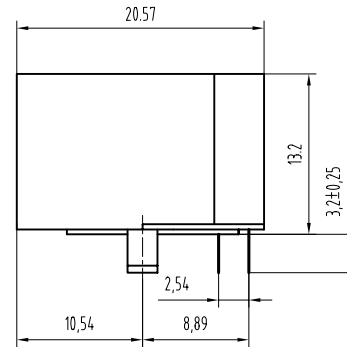
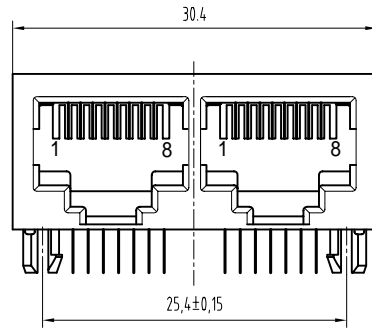

PC Board Layout
Component Side Shown

NOTES:

MATERIAL:

- 1. HOUSING MATERIAL : GLASS FILLED POLYESTER UL94V-0.
- 2. CONTACT MATERIAL : PHOSPHOR BRONZE ϕ 0.46mm.
- 3. PLATING : GOLD PLATING OVER NICKEL.

ELECTRICAL:

- 1. VOLTAGE RATING : 125 VAC RMS.
- 2. CURRENT RATING : 1.5 AMP.
- 3. CONTACT RESISTANCE : 30 MILLIOHMS MAX.
- 4. INSULATION RESISTANCE : 500 MEGOHMS MIN @ 500V DC .
- 5. DIELECTRIC WITHSTANDING RESISTANCE : 1000V AC RMS 50Hz. 1MIN.

MECHANICAL:

- 1. DURRABILITY : 750 CYCLES MIN.
- 2. PCB RETENTION PRE-SOLDER : 1 LB MIN.

ENVIRONMENTAL:

- 1. STORAGE : -40°C~+85°C
- 2. OPERATION : 0°C TO 70°C.

NUMBER:

DETAILED LISTS	MM (INCH)		DFTD: SHD	DATE: 2007.05.03	<h1 style="margin: 0;">Coorle 库乐科技</h1> <p style="margin: 5px 0;">TITLE</p> <p style="margin: 5px 0;">59A 1x2 JACK W/O SHIELD</p>
	TOLERANCES EXCEPT AS NOTED		CHKD: LANBO	DATE: 2007.05.03	
	MM		MFGO:	DATE:	
	.5 ± 0.15	±	APPLV:	DATE:	
.00 ± 0.075	±	MATERIAL :		QTY :	SIZE
.000 ± 0.05	±			FINISH :	A3
ANGLES ± 0.5				SCALE :	REV
THIRD ANGLE PROJECTION					0
DO NOT SCALE DRAWING				SHEET X	OF Y